

Usò Fognature e scarichi interrati non in presssione
Use Sewage and drainage not under pressure

**Forma manicotti dal DN/OD 800 al DN/OD 1200
e dal DN/ID 300 al DN/ID 600**

Shape of sleeves DN/OD 800 thru 1200 and DN/ID 300 thru 600

Tubi Tubi a parete strutturata in accordo al doc. UNI EN 13476
Pipes Structured-wall pipes according to doc. UNI EN 13476

Materiale PEAD
Raw Material HDPE

Marcatura Picenum Plast - EuroSewer - DN/OD - Area U - PE - Tipo B - dati produzione
Marking Picenum Plast - EuroSewer - DN/OD - Area U - PE - Tipo B - production data

Proc. produttivo Stampaggio rotazionale
Prod. process Rotational moulding

Caratteristiche geometriche manicotti dal DN/OD 800 -1200 e DN/ID 300-600 (toll. $\pm 1\%$)
Geometrical carachteristics for sleeves from DN/OD 800 thru 1200 and DN/ID 300 thru 600 (tol. $\pm 1\%$)

	Tipo PIC / PIC type			Tipo POL / POL type			
	DN/OD (mm)			DN/ID (mm)			
	800	1000	1200	300	400	500	600
Dint	810	1010	1213	363	488	604	728
DM	871	1057	1270	371	499	616	743
D1	846	1068	1270	380	512	630	751
D2	870	1098	1300	394	530	648	776
L1	165	185	205	130	153	240	270
L2	165	185	205	130	153	240	270
L	620	650	730	334	393	571	620
s	8	9	10	4	5,5	6	7,5

	Tipo POL / POL type		
	DN/OD (mm)		
	800	1000	1200
Dint	805	1005	1205
D1 = D2 =DM	870	1090	1260
L	500	550	675
s	9,5	12	12

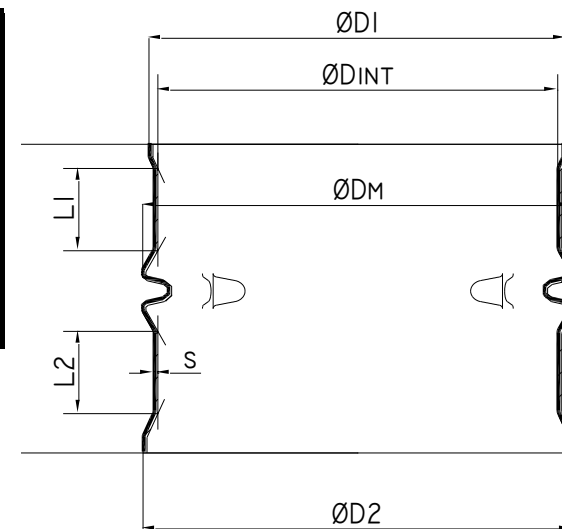
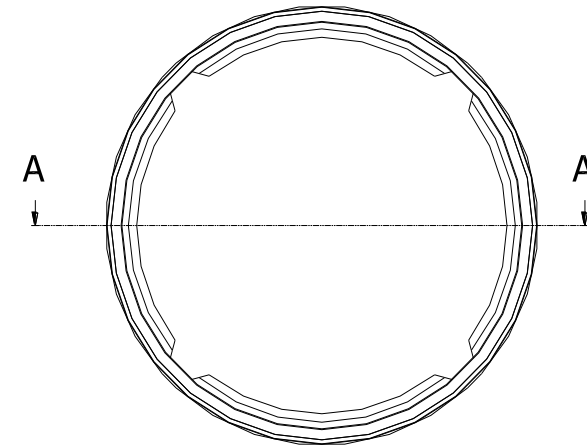

A-A

Usò Fognature e scarichi interrati non in presssione
Use Sewage and drainage not under pressure

Tubi Tubi a parete strutturata in accordo al doc. UNI EN 13476
Pipes Structured-wall pipes according to doc. UNI EN 13476

Materiale PEAD
Raw Material HDPE

Marcatura Picenum Plast - EuroSewer - DN/OD - Area U - PE - Tipo B - dati produzione
Marking Picenum Plast - EuroSewer - DN/OD - Area U - PE - Tipo B - production data

Proc. produttivo Stampaggio ad iniezione
Prod. process Injection moulding

Caratteristiche geometriche manicotti dal DN/OD 250 al DN/OD 630
Geometrical carachteristics for sleeves from DN/OD 250 to DN/OD 630

	DN/OD (mm)				
	250	315	400	500	630
D ext	270	335	432	532	670
D int	254	317	406	506	637
L	285,0	300	357	414	474
S1	8,0	9,5	12	13,5	15
S2	2,0	2,5	2,8	3,5	5
H	10,0	10	10	23	27
Peso/Weight (Kg)		1,6	15	5	8,8

Forma manicotti dal DN/OD 250 al DN/OD 630
Shape of sleeves DN/OD 250 thru DN/OD 630

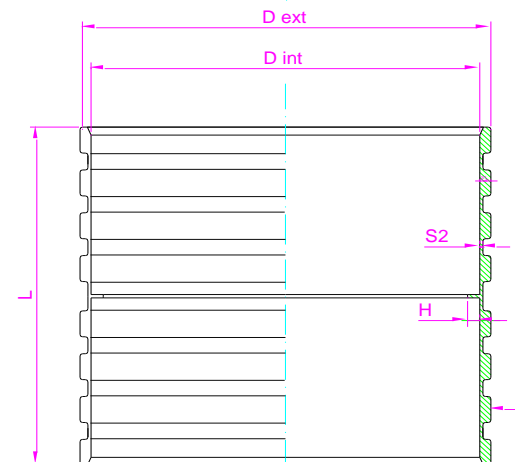
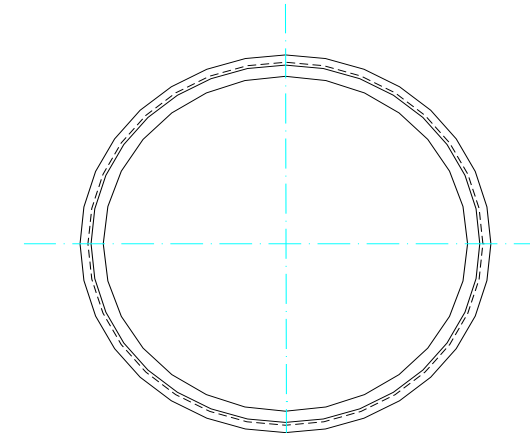

No. 8 costole di rinforzo spess. s1
No. 8 reinforcement ribs - Thickness = s1

Uso Fognature e scarichi interrati non in pressione
Use Sewage and drainage not under pressure

Tubi - Tubi a parete strutturata in accordo al doc. UNI EN 13476 (fognature e scarichi interrati non in pressione)
- Tubi a parete strutturata in accordo al doc. CEI EN 50086-2-4/A1 (tubi interrati per cavidotti)
Pipes - Structured-wall pipes according to doc. UNI EN 13476 (buried underground sewage and drainage systems)
- Structured-wall pipes according to doc. CEI EN 50086-2-4/A1 (buried pipes for cableducts)

Materiale PEAD

Raw Material HDPE

Marcatura - Picenum Plast - EuroSewer - DN/OD - Area U - PE - Tipo B - dati produzione
(solo per manicotti DN/OD 160 e DN/OD200)

Marking - Picenum Plast - EuroSewer - DN/OD - Area U - PE - Tipo B - production data
(Only for sizes DN/OD 160 and DN/OD 200)

Proc. produttivo Stampaggio ad iniezione

Prod. process Injection moulding

Forma manicotti dal DN/OD 125 al DN/OD 200
Shape of sleeves DN/OD 125 thru DN/OD 200

Caratteristiche geometriche manicotti dal DN/OD 125 al DN/OD 200

Geometrical characteristics for sleeves from DN/OD 125 to DN/OD 200

	DN/OD (mm)		
	125	160	200
D1	125,5 ± 0,5	161,0 ± 1,0	201,0 ± 1,0
Dmax	134,0 ± 1,0	172,0 ± 2,0	215,0 ± 2,0
L	180 ± 2	210 ± 2	240 ± 3
e1	2,0 ± 0,2	2,0 ± 0,2	2,5 ± 0,3
NOTE	(1) (2)		
Remarks			

- (1) Superficie esterna liscia senza costole di rinforzo
Smooth external surface (no reinforcement ribs)
- (2) Senza linguette di bloccaggio
Without locking lips

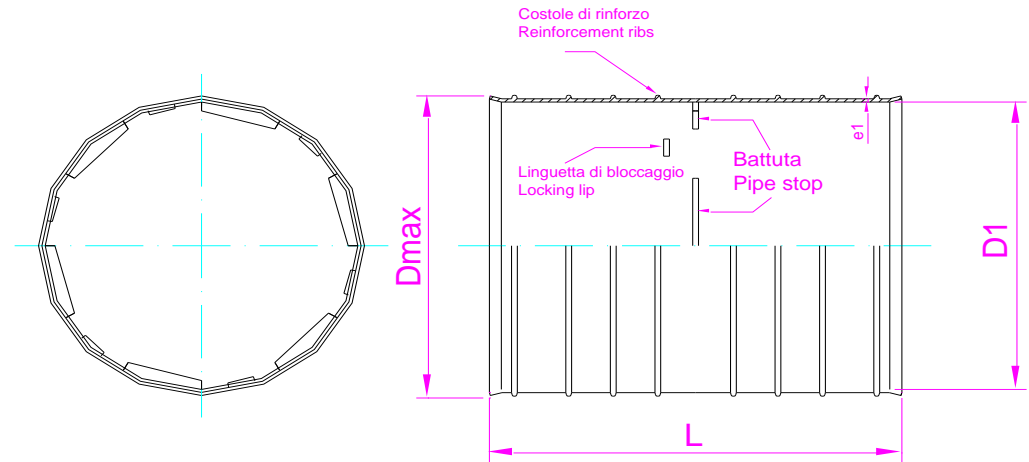

SCHEDA TECNICA MANICOTTI COR DS/ TECH DATASHEET FOR CABLEDUCT SLEEVES

Forma manicotti dal DN 40 al DN 125
Shape of sleeves from DN 40 to DN 125

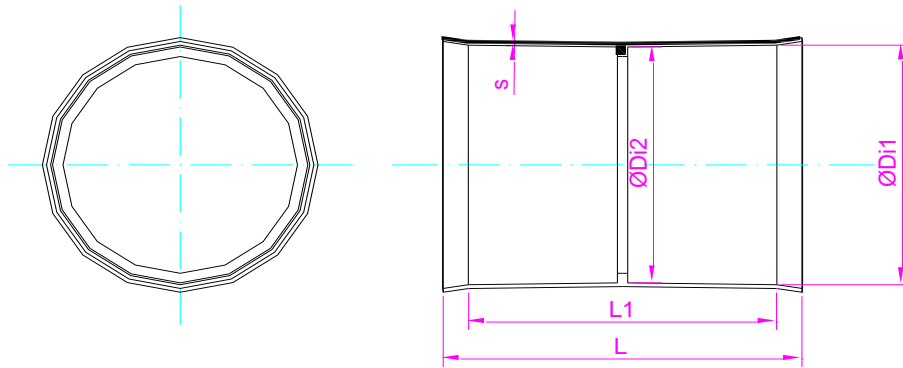

Forma manicotti dal DN 140 al DN 200
Shape of sleeves from DN 140 to DN 200

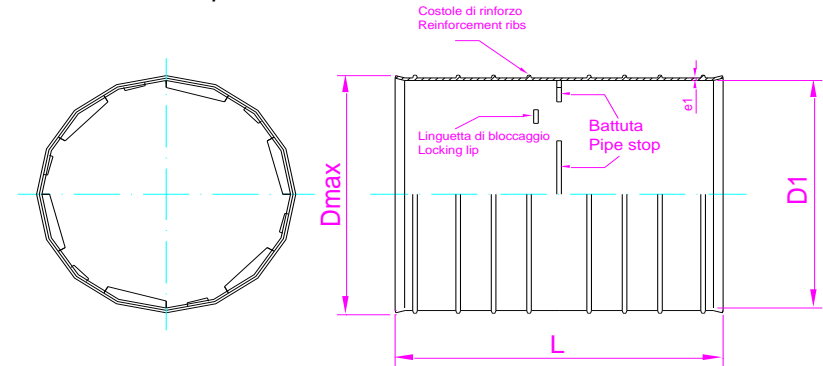

- Applicazioni:** - Tubi cavidotto (in rotoli e/o barre) conformi a CEI EN 50086-2-4/A1
 - Tubi fessurati (flessibili e/o in barre) per drenaggio di acque sotterranee
Applications: - *Cableduct pipes (coils and straight bars) according to CEI EN 50086-2-4/A1*
 - *Slotted pipes (flexible and/or straight) for underground water drainage*

Materia prima: Polietilene alta densità (PE-AD)
Raw material: High-density polyethylene (HD-PE)

Aspetto: Colore nero
Appearance: Colour black

Caratteristiche tecniche: In accordo a CEI EN 50086-2-4/A1
Technical characteristics: According to CEI EN 50086-2-4/A1

Caratteristiche dimensionali (mm): / *Dimensions (mm)*

DN	L1	L	ØDi1	ØDi2	s	NOTE - Remarks
40	64,0 ± 1,0	75,0 ± 1,0	41,1 ± 0,1	39,7 ± 0,2	1,4 ± 0,1	
50	96,0 ± 1,0	111,0 ± 1,0	50,3 ± 0,2	49,8 ± 0,2	1,5 ± 0,1	
63	99,0 ± 1,0	114,5 ± 1,0	65,4 ± 0,2	62,8 ± 0,2	1,5 ± 0,1	
75	113,0 ± 1,0	129,5 ± 1,0	76,7 ± 0,3	74,8 ± 0,2	1,5 ± 0,2	
90	123,5 ± 1,0	148,0 ± 1,0	91,1 ± 0,3	89,8 ± 0,2	1,5 ± 0,2	
110	154,0 ± 1,0	179 ± 1,0	111,1 ± 0,3	109,8 ± 0,2	1,5 ± 0,2	
125	150,5 ± 1,0	175,0 ± 1,0	126,2 ± 0,4	124,8 ± 0,2	1,8 ± 0,2	
140		202,0 ± 1,0	141,5 ± 0,4		2,0 ± 0,2	
160		175,0 ± 1,0	161,5 ± 0,4		2,0 ± 0,2	Manicotti impiegati anche su tubi UNI EN 13476 Sleeves used also with pipes according to UNI EN 13476
200		175,0 ± 1,0	201,5 ± 0,4		2,5 ± 0,2	Manicotti impiegati anche su tubi UNI EN 13476 Sleeves used also with pipes according to UNI EN 13476